

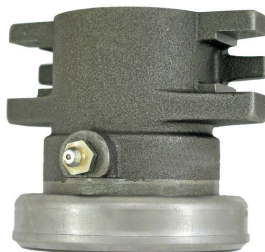

**PRODUCT SPOTLIGHT**  
 This bulletin contains valuable product related information.  
**NOVEDADES DEL PRODUCTO**  
 Este boletín contiene información valiosa relacionada a este producto.  
**ACCENT PRODUIT**  
 Ce bulletin contient de l'information utile sur les produits.



## Medium-Duty Vehicle Clutch Release Bearings



AMS Automotive offers the industry's most comprehensive lineup of medium-duty clutch release bearings, including comprehensive coverage on Japanese applications. Each bearing is engineered to exact OEM specifications using the highest quality materials, offering the ultimate in load carrying capability and operational characteristics. The following chart provides additional application and specification data. If more details are needed to verify a part number or application, please contact our technical service department at 800.528.6743.



AMS Number	Reference Number	Reference Number	Application Reference	Bearing Type
N039	613009	TK55-1A1U3	1988-02 Isuzu (various 13", 14", 15" clutches) 5.8L, 6.5L 8.4L	BO
N040	78TKI4001AR	8-97089-652-0	1995-01 GM/Isuzu Forward, NPR, Tiltmaster 3.9L	BA
N056	613016	03452-21003	1985-92 Hino FD, FE, FF, GC, SF, SG Series, 6.5L, 6.7L	BO
N057	614057	A4084	1990-07 GM (13" clutch) 6.6L, 7.0L (2.83" long)	BA
N057HD	167539	*	1990-07 GM (13" clutch) 6.6L, 7.0L, 8.1L (2.83" long)	BA
N058	614058	*	Ford (13" single disc clutch) 1993-94 6.1L; 1993-99 7.0L	BA
N059HD	257543S	12582420	2002-Up GM (13" clutch with hydraulic linkage) (4.76" long)	BA
N063	613011	65TNK20U3	1995-97 Isuzu (14" clutch) 7.1L; 1986-88 Nissan UD (13" clutch) 6.9L	BO
N1069	RCT4700SA	614141	1991-95 Mitsubishi Fuso (12" clutch) 3.9L	BA
N1171	2255-18	A2526-31	1962-79 GM (13" dual disc clutch) (Spicer trans.) 7.0L, 8.2L	BO
N1402	2005-C	A2242-511	1960-90 International (13" clutch) 3.8L, 4.2L, 4.6L, 5.0L, 5.7L, 5.8L 6.4L, 6.6L	BA-Z
N1456	CA-02135-C	A3735	1960-89 GM (12", 13" clutch) 5.7L, 6.0L, 7.0L; 1994-03 Internat. (14" clutch)	BA
N1458	I-2005-C	180155R91	International 1960-63 4.6L, 5.0L; 1960-69 6.1L	BA-Z
N1495	FB-2065-C	A2256H416	1964-93 Ford F400 - F1000	BA-Z
N1707	F-01757-C	F3HZ7548A	1960-99 Ford (13" clutch) 5.4L, 5.9L, 6.0L, 6.1L, 6.4L, 7.0L	BA-Z
N1708	FA-02256-C	E1HZ7548A	Ford (14" clutch) 1980-89 8.2L; various 1987-94 5.9L, 6.6L, 7.8L, 8.3L	BA-Z
N1709	FB-02256-C	A-2326-33	1980-89 Ford 10.4L diesel	BA-Z
N1723	FD-02256-C	F1TZ7548C	1980-92 Ford (13" dual disc clutch) 6.1L, 7.1L	BA-Z
N1736	GE-2505-C	2397509	1980-90 GM (14" clutch) 8.2L	BA
N1901	572107C91	*	1965-96 International DT360, T444, 7.3L, 9.0L	BA-Z
N1902	187144	*	1983-99 Mack MS200, MS250, 5.5L, 6.2L, 8.8L	BA-Z
N1903	187140	*	1988-08 Freightliner C-8.3, B-5.9	BA-Z
N1904	8258-065012	*	1993-99 Mack Midliner (Dana transmission) (1.87" bore)	BA
N1905	8258-318625	*	1993-99 Mack Midliner (RVI transmission) (2.20" bore)	BA
N1906	8258-318626	*	1993-99 Mack Midliner (Eaton transmission) (1.77" bore)	BA
N1908	614024	A3535-GA	1980-90 GM (14" clutch) various 3.5L, 6.1L, 7.0L, 8.2L, 10.4L	BA
N215	62TMK20-1	ME624278	1985-91 Mitsubishi Fuso various 4.9L, 5.9L, 6.6L	BO
N401	78TKC5401	1-09820-078-0	1997-01 GM/Isuzu Forward, NPR, Tiltmaster 3.9L	BO
N421	613013	55TMK09-01	1985-88 Hino FD, FE, FF, GC, SF, SG series 3.9L, 6.0L diesel	BO
N814	614076	8-94109-658-0	1985-90 GM/Isuzu Forward, NPR, Tiltmaster 3.9L	BO

\* BA - Bearing assembly

\* BA-Z - Bearing assembly with zerk fitting

\* BO - Bearing only